

Luveris®

(LUTROPIN ALFA FOR INJECTION)

Administration of Luveris® 75 IU

REVIEW THESE STEPS BEFORE YOU ADMINISTER LUVERIS®

Get ready

1. Make sure you have all the necessary materials assembled in a clean area: one Luveris® 75 IU vial, one vial with sterile water (diluent), one syringe, two needles, alcohol swabs, gauze, bandage, sharps bin. (The syringe, needles, alcohol swabs, gauze, bandage and sharps bin are not included in the Luveris® package.)



Luveris® diluent Luveris® powder



SYRINGE, RECONSTITUTION AND ADMINISTRATION NEEDLES



SHARPS BIN AND ALCOHOL SWABS

2. Wash your hands thoroughly.



3. Remove the plastic caps from the vial of Luveris® powder and the vial with the diluent, with your thumb.



4. Wipe the rubber stoppers with an alcohol swab. The rubber stoppers should not be touched once wiped.



Allow the Luveris® diluent to adjust to room temperature before you administer your injection.

Check that the Luveris® diluent is clear. Do not use if it contains any particles.

FILLING THE SYRINGE WITH THE LUVERIS® DILUENT

Draw air into the syringe

5. Remove the wrapping from the syringe and reconstitution needle.

6. Attach the needle onto the syringe and carefully pull or twist off the needle cap of the reconstitution needle. Do not touch the needle or allow it to touch any surface.



7. Draw some air into the syringe by pulling the plunger approximately to the 1 mL / 1 cc mark.



Inject air into the vial of sterile water

8. Place the vial of diluent on a hard, flat surface.

9. Carefully insert the needle through the center of the rubber stopper into the vial of sterile water (diluent). Keep the syringe in a straight, upright position as you insert the needle or it may be difficult to depress the plunger.



10. Gently inject the air into the vial by depressing the plunger on the syringe (the injected air creates pressure and makes it easier to withdraw the solution).



Fill the syringe with diluent

11. Without removing the needle, turn the vial upside down and withdraw all of the diluent into the syringe, making sure that the tip of the needle remains in the water (diluent) by slowly backing it out of the vial.



12. Remove the needle from the vial.

RECONSTITUTING LUVERIS®

Inject the diluent into the Luveris® powder

13. Place the vial containing the Luveris® powder on a hard, flat surface.

14. Insert the needle through the center of the rubber stopper into the Luveris® vial. Keep the syringe in a straight, upward position as you insert the needle or it may be difficult to depress the plunger.



15. Slowly inject the sterile water (diluent) into the vial with Luveris® powder by depressing the plunger on the syringe.



Obtain a clear solution

16. Leaving the needle in the vial, gently rotate the vial between your fingers until all of the powder is dissolved. Do not shake.



Side effects may occur with the use of infertility drugs and, therefore, should only be prescribed by physicians who are thoroughly familiar with infertility problems and their management. Ovarian hyperstimulation syndrome (OHSS), with or without vascular and pulmonary complications, can occur with the use of infertility drugs. Reports of multiple births have been associated with gonadotropin treatments. The most common side effects in women using Luveris® include headache, abdominal pain, nausea, OHSS, breast pain, and ovarian cyst. Please see Full Prescribing Information (PI) for product details.

Preparing the administration of Luveris® 75 IU and injecting your dose

Draw the Luveris® solution back into the syringe

17. When all the powder has dissolved, without removing the needle, turn the syringe and vial upside down and gently withdraw all the Luveris® solution back into the syringe.



Make sure that the tip of the needle remains in the solution by slowly backing the needle out of the vial to withdraw as much of the solution as possible.

To control the movement of the needle in the solution, look from the side of the vial through the gap in the rubber stopper.

18. Carefully remove the needle from the vial.

PREPARING THE ADMINISTRATION

Change needles

19. Recap the reconstitution needle (1). Twist the cap and needle off the syringe (2).



20. Remove the wrapping from the administration needle. Twist the needle onto the end of the syringe (3) and carefully remove its cap (4).

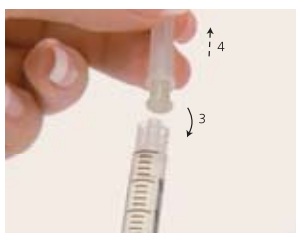

Remove air bubbles

21. To remove any air bubbles, point the needle upwards and gently tap the syringe.



22. When all bubbles rise, slightly push the plunger until a small drop appears from the tip of the needle.



23. Recap the syringe needle.

Now you are ready to administer your Luveris® 75 IU injection.

INJECTING YOUR DOSE

Prepare the injection area

24. Choose an injection site as directed by your nurse, doctor or pharmacist. Alternate the injection sites each day.



25. Carefully clean the injection site with an alcohol swab and allow it to air-dry.



Remember that your injection materials must be kept sterile and cannot be reused.

Administer your injection

26. Uncap the syringe needle. Holding the syringe with one hand as you would hold a pencil, pinch the skin of the chosen injection site with the other hand and hold firmly.



27. Insert the entire length of the needle into the skin at an upward angle of about 45 to 90 degrees. Do not inject into a vein.



28. Release the hand pinching the skin and depress the plunger in a slow, steady motion until all the medication is injected. Do not inject into a vein.



29. Gently withdraw the needle.

30. Apply gentle pressure to the injection site using sterile gauze. Put a small adhesive bandage strip over the injection site if desired.



Discard used materials

31. Do not recap the needle. Discard the used needle and syringe into your safety container.



These are common instructions for administering your injection. However, you should always follow the advice given by your nurse or doctor.

Use the Luveris® solution only if all the powder has dissolved and the liquid is clear and colorless. Inject your Luveris® dose immediately upon reconstitution.

Storage of Luveris® 75 IU

Important: Luveris® is stored either refrigerated (36°-46°F/2-8°C) or at room temperature (up to 77°F/25°C) in its original package. Protect from light. Do not freeze. Do not store above 77°F (25°C). Do not use after the expiration date shown on the vial or the carton. Keep out of the reach of children.

